



DURATION WINDOWS

Secondary Glazing Measuring and Installing

Units 4-5 Charfleets Road, Canvey Island, Essex, SS8 0PQ

Tel: 01268 681612 Fax: 01268 510058 Email: sales@duration.co.uk Website: www.duration.co.uk

Secondary Glazing Guide To Measuring And Fitting

Contents

Measuring Secondary Glazing

Faceted Bay Window	Page 3
Square Bay Window	Page 4

Installing Secondary Glazing

Economy Odd Leg	Page 5
Subframe- Face Fix	Page 6
Subframe- Reveal Fix	Page 7
Heavy Duty	Page 8

Measuring

Measuring For Faceted Bay Windows

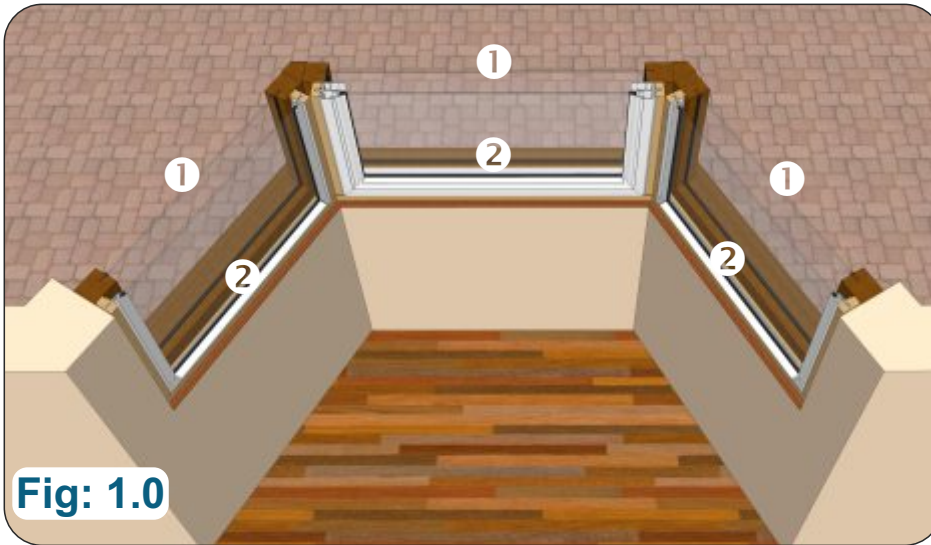

Key

- ① Prime Window
- ② Secondary Glazing

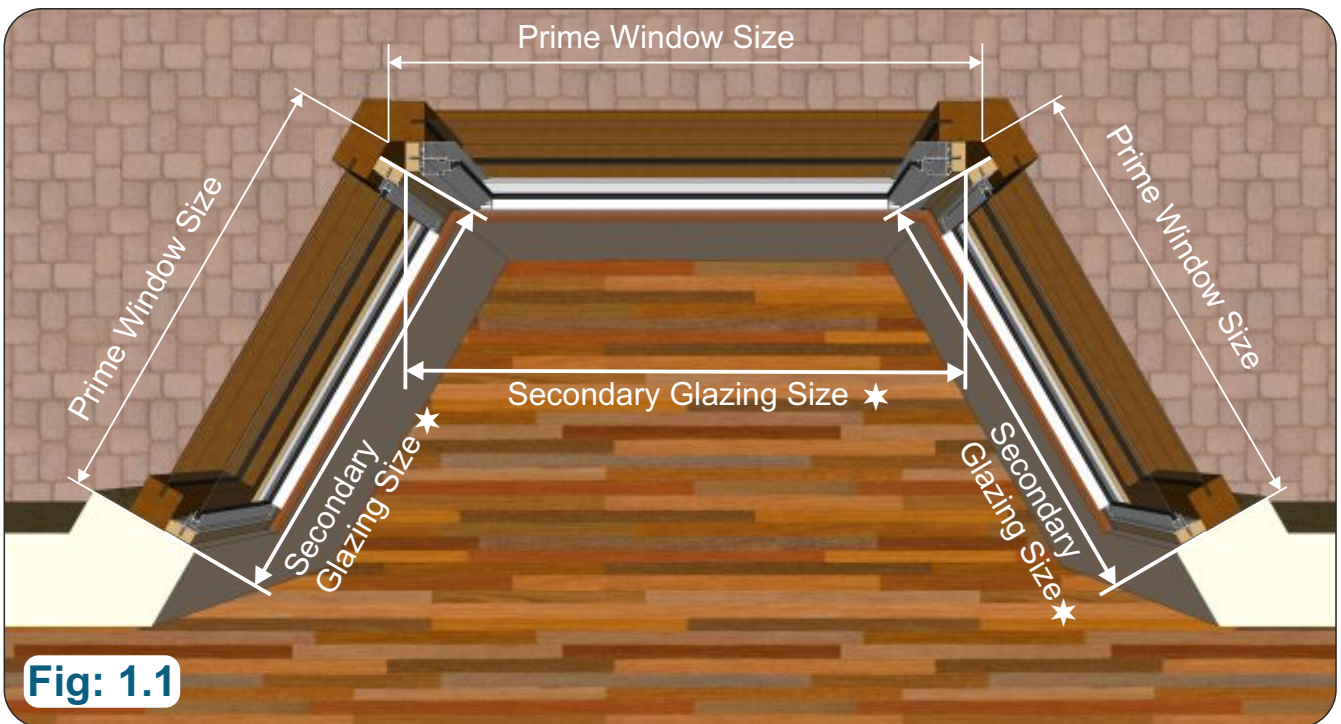

Fig 1.0 Shows a cut through of a faceted bay window with secondary installed.

Fig 1.1 Shows the cut through of the prime window and secondary with dimension lines. This image aims to help when measuring for the secondary glazing.

To obtain secondary survey sizes project into the room from the window by 39mm for SF1 or 55mm for SF3 subframes. Take the measurements for the secondary glazing from these projected points (Fig:1.1).

★ Also remember to allow for a fitting tolerance on the secondary sizes. This is to allow for small discrepancies in the trueness of the original window reveal.

Measuring

Measuring For Square Bay Windows

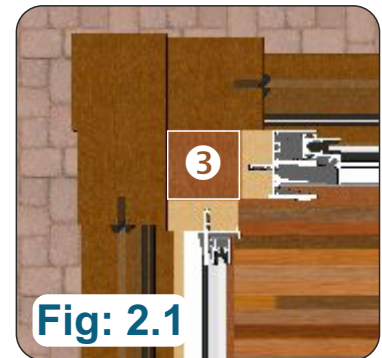
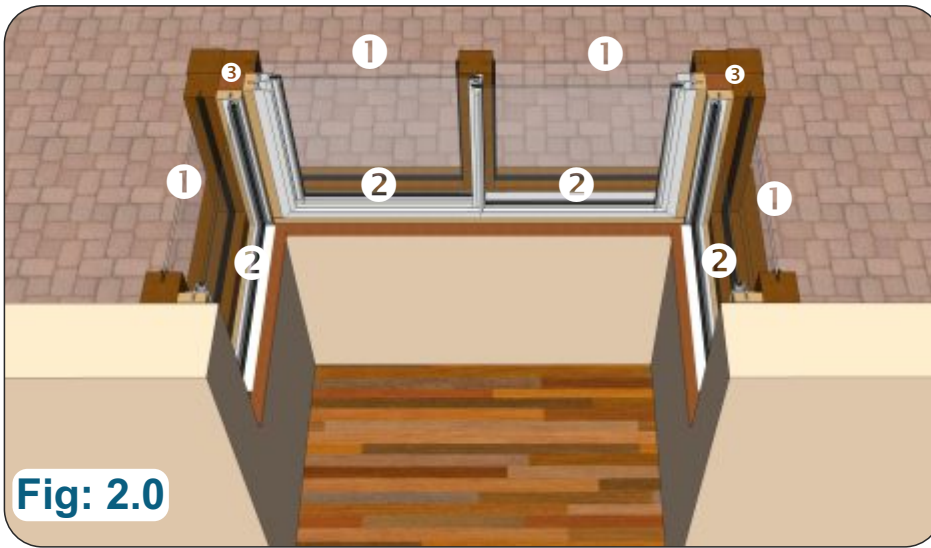

Key

- ① Prime Window
- ② Secondary Glazing
- ③ Wood Corner Post



Fig 2.0 Shows a cut through of a square bay window with secondary installed.

Fig 2.1 Shows a close up of where the two pieces of secondary glazing will meet. Point 3 shows a wooden corner post. This post is optional and is not supplied by Duration Windows.

Fig 2.2 Shows the cut through of the prime window and secondary with dimension lines. This image aims to help when measuring for the secondary glazing.

To obtain secondary survey sizes project into the room from the window by 39mm for SF1 or 55mm for SF3 subframes. Take the measurements for the secondary glazing from these projected points. (Fig:2.1).

★ Also remember to allow for a fitting tolerance on the secondary sizes. This is to allow for small discrepancies in the trueness of the original window reveal.

Installing

Note: When screwing into walls please check to avoid pipes, electrics and cables.

Economy Secondary Glazing

This is face fix system only. There is no subframe and no trims.



- 1 Locate secondary frame into aperture. Make sure secondary is level before moving onto fixing.



- 2 Screw directly into the existing window using the pre-drilled holes on the odd leg frame. (While fixing make sure secondary is level)

Note that fitting screws are not supplied with any of our secondary systems.



- 3 Insert each panel into the frame. Once assembled check that all panels work correctly. If not adjust where needed.



- 4 Note that packing could be required beneath the secondary frame to support the weight of the panels. This support will not be provide and will require your own judgment.

Installing

Note: When screwing into walls please check to avoid pipes, electrics and cables.

Luxury Subframe - Face Fix



- 1 Locate secondary frame into aperture.
- 2 Pack / temporarily fix. Ensure that the frame and cill are level with each other and correctly supported.
- 3 Ensure panels fit correctly. Check that interlocks and sight lines look correct and all operate freely.



- 4 Fix frame 150mm from each corner and at 800mm intervals. There should be no less than two fixings per side.
- 5 Check all panels, locks and catches work correctly.

Note that fitting screws are not supplied with any of our secondary systems.



- 6 Cut and mitre beads to suit the frame. Using your own judgement obtain the best possible sight lines between frame and beads, these may not run 100% parallel and over lap metal depending on trueness of reveal. Attach trims in place using super glue or silicone.



- 7 Apply the smallest possible acrylic seal between the reveal and the trim (size depends on trueness of reveals).

Installing

Note: When screwing into walls please check to avoid pipes, electrics and cables.

Luxury Subframe - Reveal Fix



- 1 Locate secondary frame into aperture.
- 2 Pack / temporarily fix. Ensure that the frame and cill are level with each other and correctly supported.
- 3 Ensure panels fit correctly. Check that interlocks and sight lines look correct and all operate freely.



- 4 Fix frame 150mm from each corner and at 800mm intervals. There should be no less than two fixings per side.
- 5 Apply an acrylic seal between reveal and frame neatly.

Note that fitting screws are not supplied with any of our secondary systems.



- 6 Check all panels, locks and catches work correctly.
- 7 Cut and mitre beads to suit the frame. Using your own judgement obtain the best possible sight lines between frame and beads, these may not run 100% parallel and over lap metal depending on trueness of reveal. Attach trims in place using super glue or silicone.

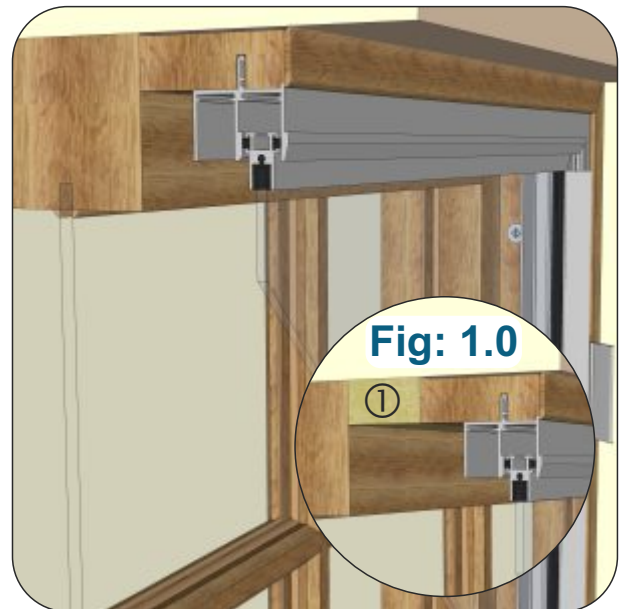

- 8 Apply the smallest possible acrylic seal between the reveal and the trim (size depends on trueness of reveals).

Fig:1.0: Acoustic tile (1) placed in cavity between prime window and secondary glazing for extra noise reduction. This is not supplied by Duration Windows.

Installing

Note: When screwing into walls please check to avoid pipes, electrics and cables.

Heavy Duty

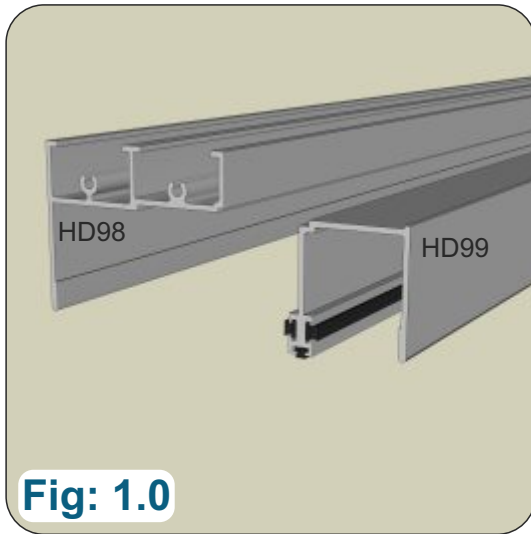

Fig: 1.0

- 1 Remove section HD99 head insert from section HD98 head. (Fig 1.0)
- 2 Assemble the outer frame sections, HD97 jambs, HD98 head and HD103 track, using No 6x1" self tapping screws.



- 3 Locate the outer frame into the reveal in the position required and fix in place. Pack the frame as required to ensure it is installed square and true in every aspect.



- 4 Insert correct panel into the back track of the cill and push into the vertical position and support it to prevent it falling forward (ensure interlock is facing into the room).



- 5 Insert the remaining panel into the front track of the cill (ensure the interlock is facing towards the prime window) and place the head insert HD99 on top of the panel and push the complete assembly into the vertical position and hold in place. Locate the head inset profile into the correct position and fix using self tapping screws. Move the panel along the track to gain access to all of the screws.

- 6 Check secondary is operating correctly then trim around the perimeter as required.